

Inside the box  
Dans la boîte

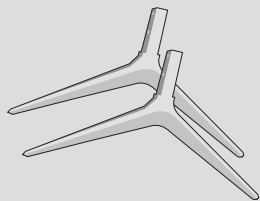

Smart TV  
Smart TV



TV Stands  
Supports de TV

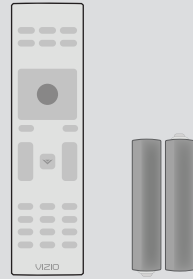

Remote with Batteries  
Télécommande avec piles

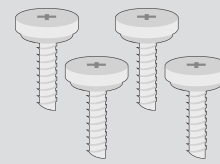

4x Screws for TV Stands  
4x Vis Pour supports de TV

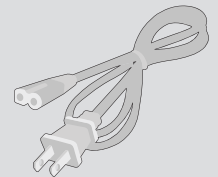

Power Cable  
Câble d'alimentation

1

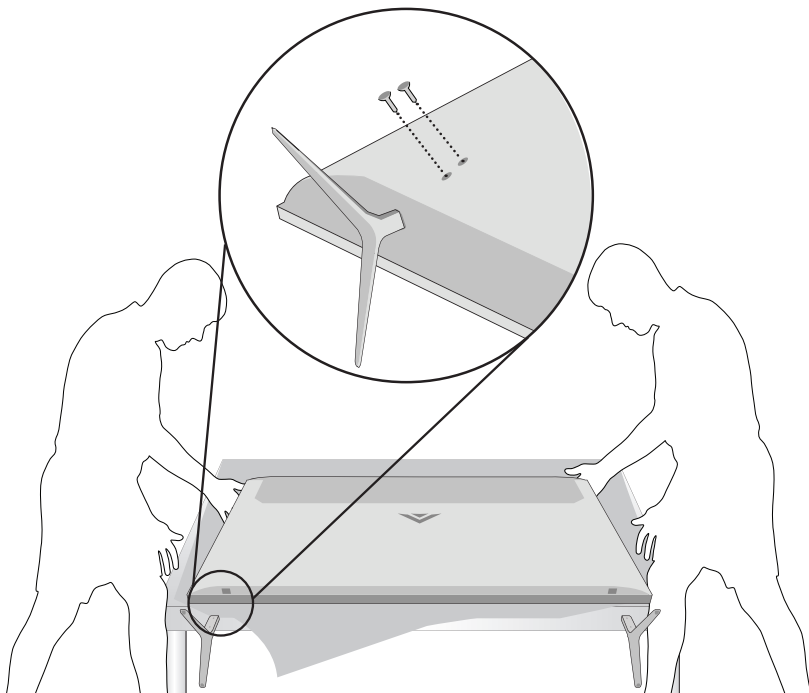

2

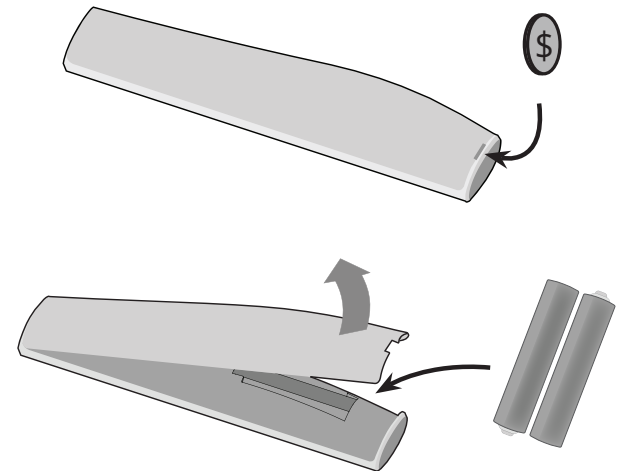

3

**Plug the tv power cord into a wall outlet. For more information on connecting your devices refer to the User Manual.**  
Branchez le cordon d'alimentation de la tv dans une prise murale. Référez-vous au manuel d'utilisation pour plus d'information sur le branchement de vos appareils.

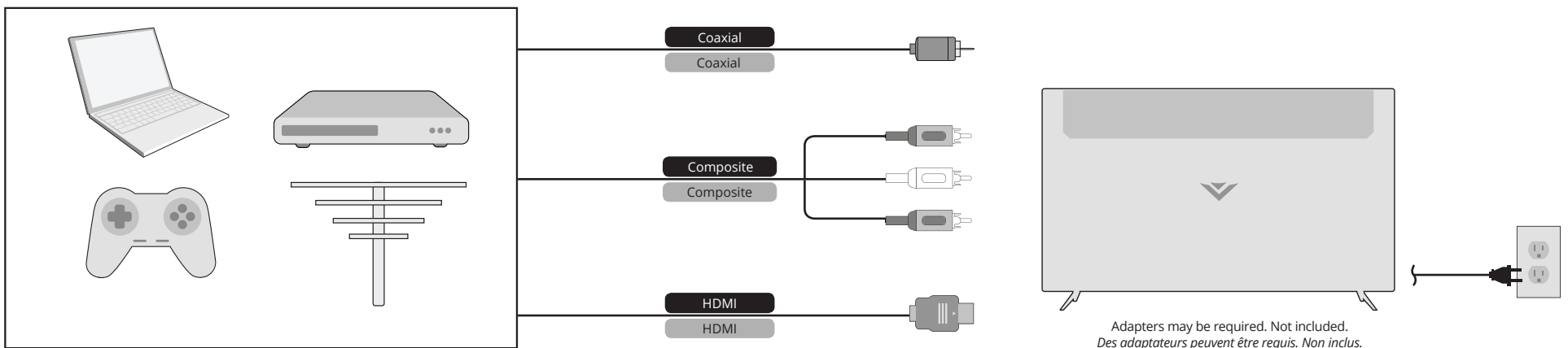

4

**Follow on-screen instructions to complete setup.**  
Suivez les instructions à l'écran pour effectuer la installation.



**For more information including the product's full User manual, visit VIZIO.com.**

Pour plus d'informations, y compris manuel complet de l'utilisateur du produit, visitez VIZIO.com.

**How to Text VIZIO Support**

Using your mobile device, send a text message to:

**205-301-3729**

Note: This number accepts SMS/MMS messages only.

**No voice calls accepted.** Message and data rates may apply. U.S. only.