

# VIZIO



## **QUICK START GUIDE**

Model: SB3820-C6

# IMPORTANT SAFETY INSTRUCTIONS

Your Unit is designed and manufactured to operate within defined design limits, and misuse may result in electric shock or fire. To prevent your Unit from being damaged, the following rules should be observed for its installation, use, and maintenance. Please read the following safety instructions before operating your Unit. Keep these instructions in a safe place for future reference.

- Read these instructions.
- Keep these instructions.
- Heed all warnings.
- Follow all instructions.
- Do not use this apparatus near water.
- Clean only with a dry cloth.
- Do not block any ventilation openings. Install in accordance with the manufacturer's instructions.
- Do not install near any heat sources such as radiators, heat registers, stoves, or other apparatus (including amplifiers) that produce heat.
- Do not defeat the safety purpose of the polarized or grounding-type plug. A polarized plug has two blades with one wider than the other. A grounding type plug has two blades and a third grounding prong. The wide blade or the third prong are provided for your safety. If the provided plug does not fit into your outlet, consult an electrician for replacement of the obsolete outlet.
- Protect the power cord from being walked on or pinched, particularly at plugs, convenience receptacles, and the point where they exit from the apparatus.
- Only use attachments/accessories specified by the manufacturer.
- Use only with the cart, stand, tripod, bracket, or table specified by the manufacturer, or sold with the apparatus. When a cart is used, use caution when moving the cart/apparatus combination to avoid injury from tip-over. 
- Unplug this apparatus during lightning storms or when unused for long periods of time.
- Refer all servicing to qualified service personnel. Servicing is required when the apparatus has been damaged in any way, such as when the power supply cord or plug is damaged, liquid has been spilled or objects have fallen into the apparatus, the apparatus has been exposed to rain or moisture, does not operate normally, or has been dropped.
- To reduce the risk of electric shock or component damage, switch off the power before connecting other components to your Unit.
- Unplug the power cord before cleaning your Unit. A damp cloth is sufficient for cleaning. Do not use a liquid or a spray cleaner on your Unit. Do not use abrasive cleaners.
- Always use the accessories recommended by the manufacturer to insure compatibility.
- When moving your Unit from an area of low temperature to an area of high temperature, condensation may form in the housing. Wait before turning on your Unit to avoid causing fire, electric shock, or component damage.
- Slots and openings in the back and bottom of the cabinet are provided for ventilation. To ensure reliable operation of your Unit and to protect it from overheating, be sure these openings are not blocked or covered. Do not place your Unit in a bookcase or cabinet unless proper ventilation is provided.
- Never push any object into the slots and openings on your Unit enclosure. Do not place any objects on the top of your Unit. Doing so could short circuit parts causing a fire or electric shock. Never spill liquids on your Unit.
- When connected to a power outlet, power is always flowing into your Unit. To totally disconnect power, unplug the power cord.
- Do not overload power strips and extension cords. Overloading can result in fire or electric shock.

- The wall socket should be located near your Unit and be easily accessible
- Keep your Unit away from moisture. Do not expose your Unit to rain or moisture. If water penetrates into your Unit, unplug the power cord and contact your dealer. Continuous use in this case may result in fire or electric shock.
- Do not use your Unit if any abnormality occurs. If any smoke or odor becomes apparent, unplug the power cord and contact your dealer immediately. Do not try to repair your unit yourself.
- Avoid using dropped or damaged appliances. If your Unit is dropped and the housing is damaged, the internal components may function abnormally. Unplug the power cord immediately and contact your dealer for repair. Continued use of your Unit may cause fire or electric shock.
- Do not install your Unit in an area with heavy dust or high humidity. Operating your Unit in environments with heavy dust or high humidity may cause fire or electric shock.
- Ensure that the power cord and any other cables are unplugged before moving your Unit.
- When unplugging your Unit, hold the power plug, not the cord. Pulling on the power cord may damage the wires inside the cord and cause fire or electric shock. When your Unit will not be used for an extended period of time, unplug the power cord.
- To reduce risk of electric shock, do not touch the connector with wet hands.
- Insert the remote control batteries in accordance with instructions. Incorrect polarity may cause the battery to leak which can damage the remote control or injure the operator.
- See the important note and rating located on the back of the unit.
- **WARNING** - This equipment is not waterproof. To prevent a fire or shock hazard, do not place any container filled with liquid near the equipment (such as a vase or flower pot) or expose it to dripping, splashing, rain, or moisture.
- **CAUTION** - Danger of explosion or fire if batteries are mistreated. Replace only with the same or specified type.
- Do not leave the batteries exposed to direct sunlight for a long period of time with doors and windows closed. Do not disassemble the batteries or dispose of it in fire.
- Where the MAINS plug or appliance coupler is used as the disconnect device, the disconnect device shall remain readily operable.

**WARNING:** To reduce the risk of fire or electric shock, do not expose this apparatus to rain or moisture.

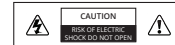

The lightning flash with arrowhead symbol within an equilateral triangle is intended to alert the user to the presence of not isolated dangerous voltage within the product that may be sufficient magnitude to constitute a risk of shock to persons.



The exclamation point within an equilateral triangle is intended to alert the user to the presence of important operating and servicing instructions in the literature accompanying the appliance.



**Warning:** This equipment is a Class II or double insulated electrical appliance. It has been designed in such a way that it does not require a safety connection to electrical earth.

# TABLE OF CONTENTS

- Package Contents ..... 4
- Controls & Connections ..... 5
- First-Time Setup..... 7
- Using the Remote ..... 11
- LED Indicators..... 12
- Bluetooth Pairing..... 14
- Using Bluetooth mode ..... 15
- Advanced Setup..... 16
- Connecting a Subwoofer ..... 17
- Using Button Combinations ..... 18
- Wall-Mounting the Sound Bar ..... 19
- One-Year Limited Warranty..... 26
- Legal & Compliance..... 27

# PACKAGE CONTENTS



High Definition Sound Bar



Remote Control with  
2 x AAA Batteries



This Quick  
Start Guide



Power Cable



Coaxial Audio  
Cable



Stereo RCA  
to 3.5mm  
Audio Cable



Digital Optical  
Cable



2 x Sound Bar  
Wall Mount  
Brackets



2 x Wall  
Mount Screws  
(Size: M4 x 10mm)



Wall Mount  
Template

# CONTROLS & CONNECTIONS

## Back of Sound Bar

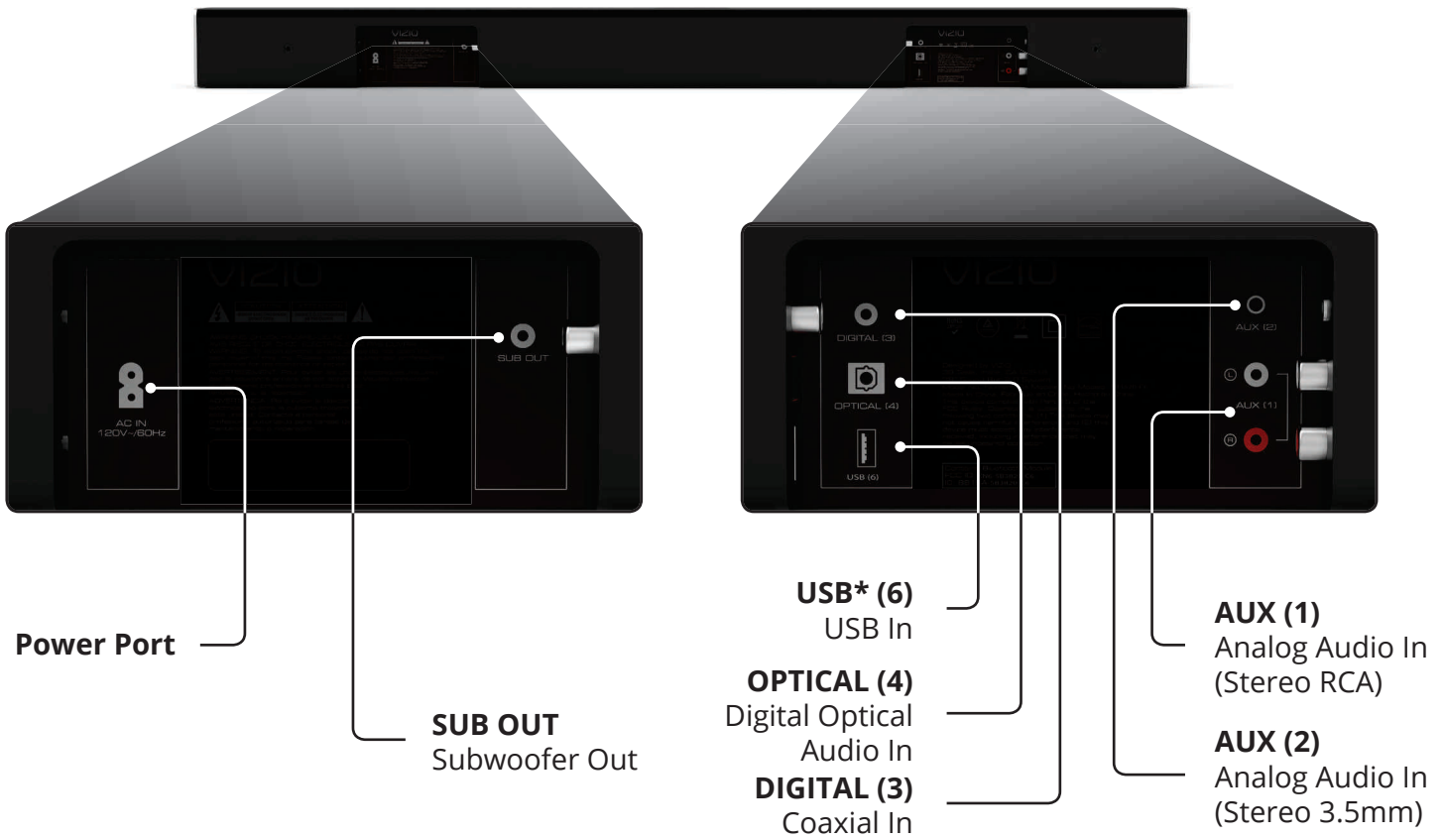

\* Supports .WAV file format playback only.

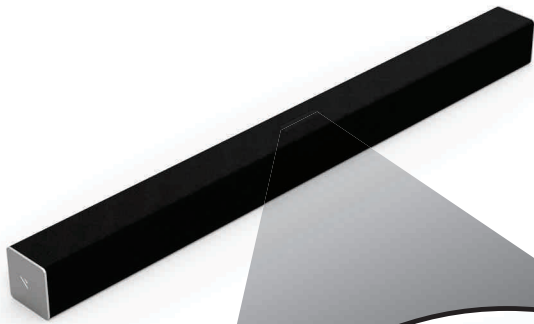

**Bluetooth Input** Hold to pair.  
(See 'Bluetooth Pairing' for more information.)

**Volume** Increase or decrease the loudness of the audio.

**Input** Press to change the audio source.

**Power** Press to turn soundbar on or off.

**Top of Sound Bar**

# FIRST-TIME SETUP

1

CHOOSE ONE CABLE

GOOD

OR

BETTER



Back of Sound Bar

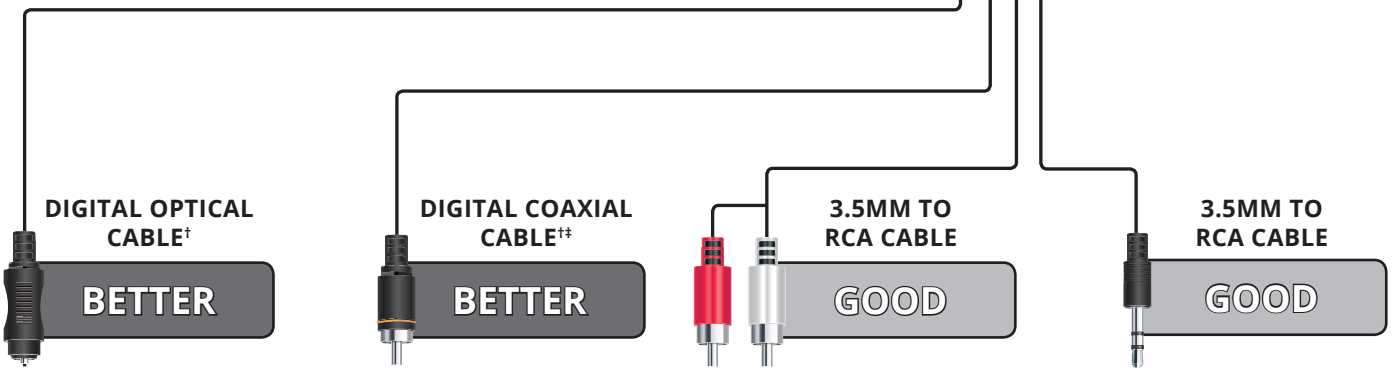

DIGITAL OPTICAL CABLE<sup>†</sup>

BETTER

DIGITAL COAXIAL CABLE<sup>‡</sup>

BETTER

3.5MM TO RCA CABLE

GOOD

3.5MM TO RCA CABLE

GOOD

AND CONNECT IT TO YOUR TV



\* Not all TVs have the audio outputs shown above. To connect the Sound Bar directly to your other devices (Blu-Ray player, game system, etc.) see your device's user manual.

† When using either of the Digital Inputs, if there is no audio: (A) try setting the TV output to PCM or (B) Connect directly to your Blu-ray/other source, some TVs do not pass through digital audio.

‡ Cable not included.

**2** Connect the power cable to the Sound Bar **AC IN** as shown.

Plug the power cable into an electrical outlet.

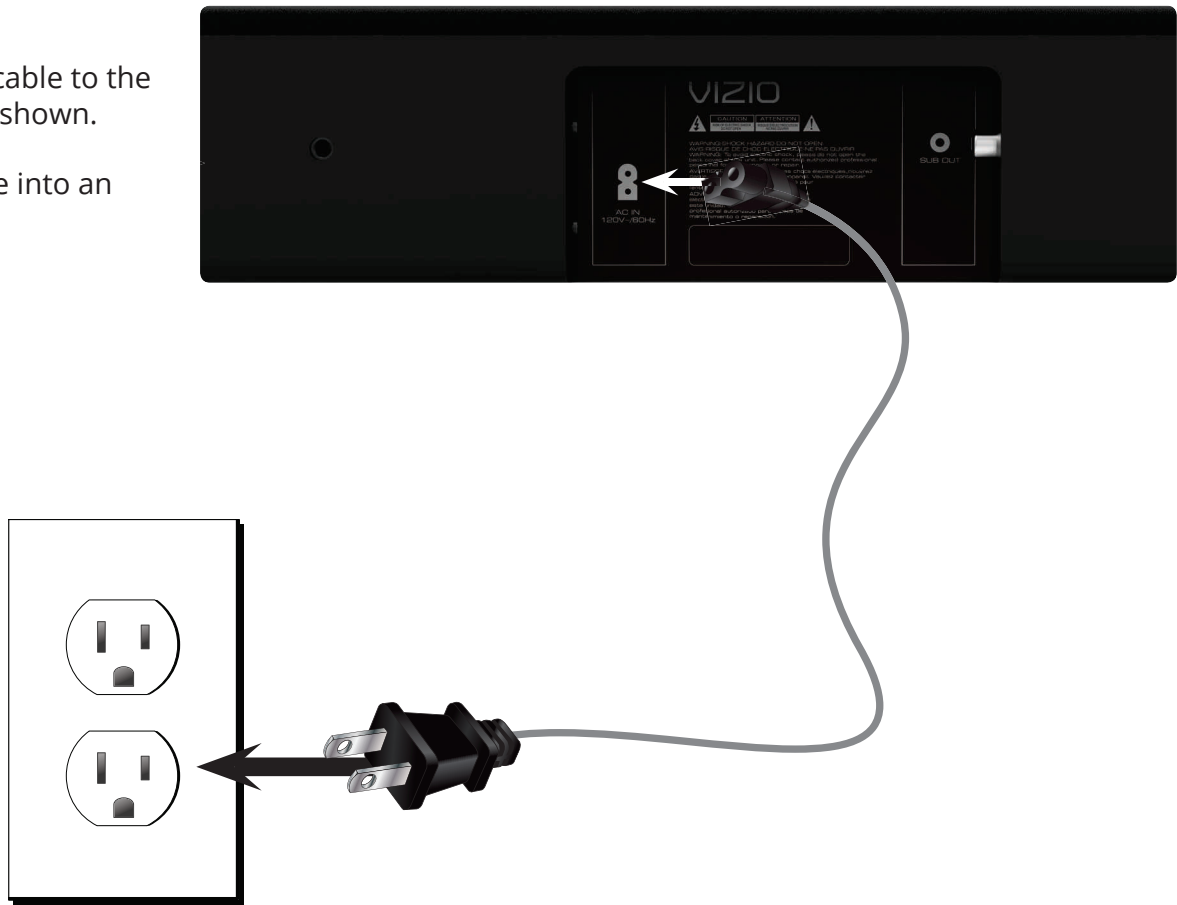



**3**

For the best surround sound experience, position the Sound Bar as shown. The Sound Bar should be close to ear level.



Sound Bar is centered  
below the TV.

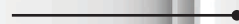

4



Remove the battery cover by gently sliding it away from the remote.

5



Insert the included batteries and gently slide the battery cover back into place.

6

Turn your TV on, the Sound Bar will automatically turn on and begin searching for an active input.

The LED indicators on the front of the Sound Bar will begin cycling in pairs through inputs until an audio source is detected.\*



**Tip:** Pressing the **INPUT** button will stop the auto detect function.

You can press the **INPUT** button to switch between audio sources. For example, if you connected your TV to Input 1, set the Sound Bar to Input 1.

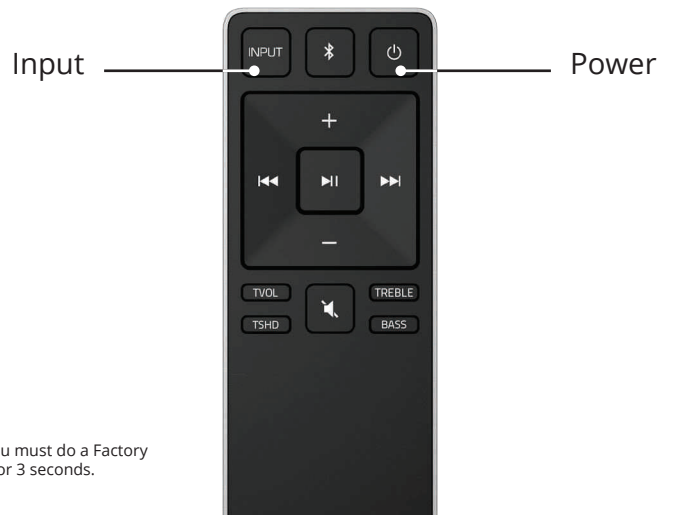

\* Auto detect function only occurs once when the Sound Bar is first powered on. To enable this feature again, you must do a Factory Reset (see the *Using Button Combinations* section for more information) or press and hold the INPUT button for 3 seconds.

# USING THE REMOTE

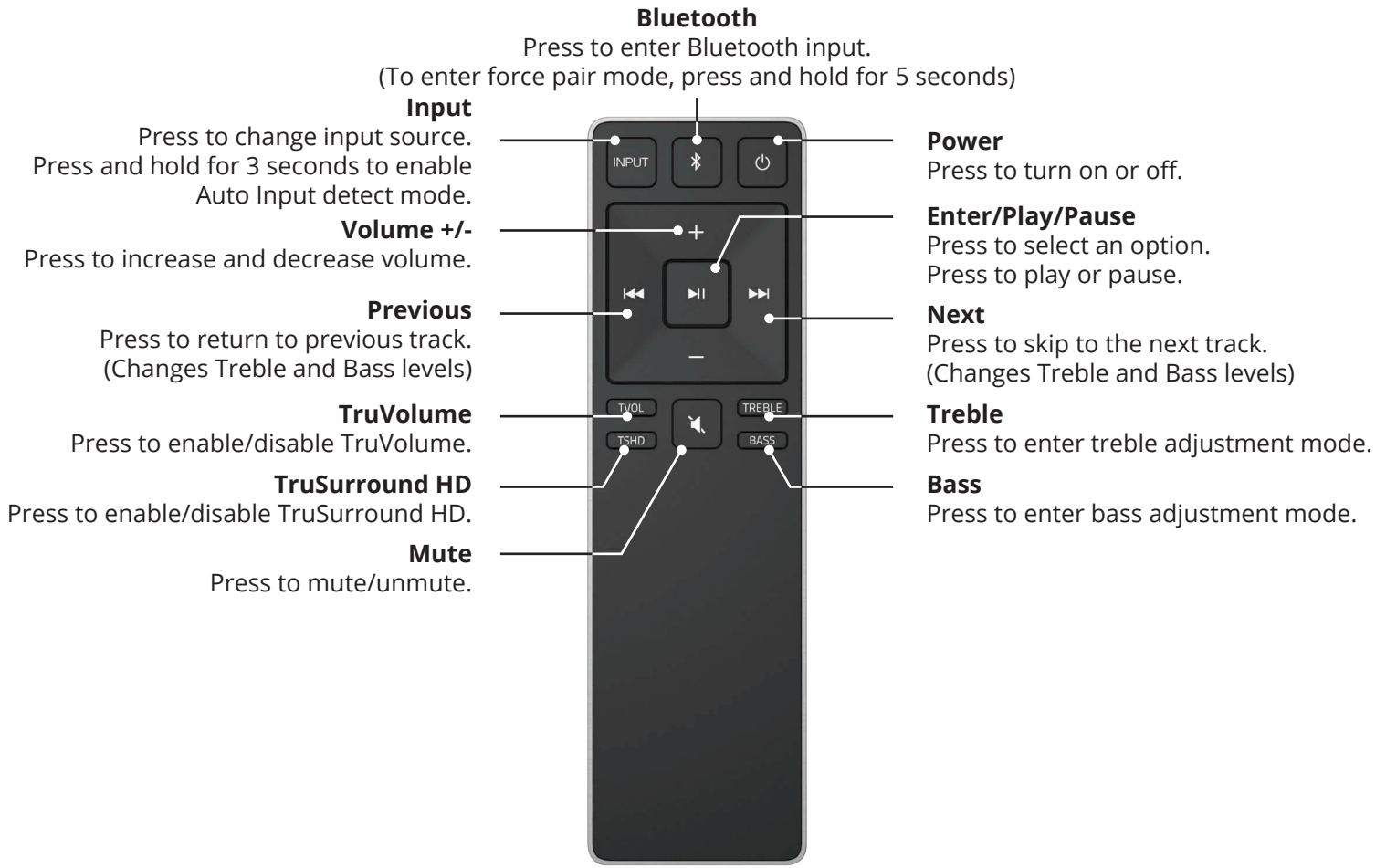





# LED INDICATORS

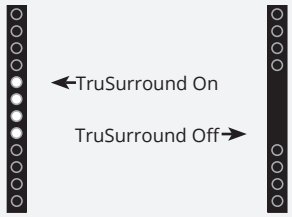

**LED Indicators are located here.**

The LED Indicators will behave differently with each button on the remote control.

Function	LED Behavior	Description
<b>Input</b>		<p>Press the INPUT button on the remote to cycle through the available inputs:</p> <ul style="list-style-type: none"> <li>• Analog Audio In - AUX Stereo RCA (1)</li> <li>• Analog Audio In - AUX Stereo 3.5mm (2)</li> <li>• Coaxial In - Digital (3)</li> <li>• Digital Optical Audio In - Optical (4)</li> <li>• Bluetooth</li> <li>• USB In - USB (6)</li> </ul>
<b>Bluetooth Pairing</b>	<p>(When searching for device) Flash from the bottom to top and back continuously.</p>	<p>Press and hold the  button on the remote. The Sound Bar will be discoverable for 15 minutes. You can now search for the Sound Bar (VIZIO SB3820) using your Bluetooth Device. The sound bar will power down if no device is found.</p> <p><b>Note:</b> Set your Bluetooth device into pairing mode prior to the Sound Bar.</p>
<b>DTS TruVolume On/Off</b>	<p>← TruVolume On</p> <p>TruVolume Off →</p>	<p>Press the <b>TVOL</b> button to enable/disable TruVolume.</p> <p>When enabled (On), TruVolume provides a consistent and comfortable volume level for a more enjoyable listening experience.</p>

Function	LED Behavior	Description
<p><b>DTS TruSurround On/Off</b></p>	 <p>←TruSurround On</p> <p>TruSurround Off→</p>	<p>Press the <b>TSHD</b> button to enable/disable DTS TruSurround. When enabled (On), all inputs will produce virtual surround sound. When disabled (Off), all sources will playback in stereo.</p>
<p><b>Treble Levels</b></p>	 <p>Two center LEDs indicate Treble level 0.</p>	<p>Press the <b>TREBLE</b> button then press the <b>Next/Previous</b> button to increase/decrease the treble level. The LED indicators will move to the top with increasing levels and to the bottom with decreasing levels.</p>
<p><b>Bass Levels</b></p>	 <p>Two center LEDs indicate Bass level 0.</p>	<p>Press the <b>BASS</b> button then press the <b>Next/Previous</b> button to increase/decrease the bass level. The LED indicators will move to the top with increasing levels and to the bottom with decreasing levels.</p>
<p><b>When a Dolby Digital signal is detected.</b></p>	 <p>Dolby Digital Indicator LED</p>	<p>Dolby Digital is only available on either the <b>Coaxial In</b> or <b>Digital Optical Audio In</b> inputs. When a Dolby Digital signal is detected, the Dolby Digital indicator LED will light up for 3 seconds before fading away.</p>

## BLUETOOTH PAIRING

To pair the Sound Bar with a Bluetooth device:

1. Press and hold the **Bluetooth** button  on the Sound Bar or the **Bluetooth** button  on the remote for five (5) seconds. When the Sound Bar is in Bluetooth Pairing Mode, the LED Indicators on the Display Panel on the front of the Sound Bar will light sequentially from bottom to top and back again.

Once the device is paired, the LED Indicators will stop flashing.

2. You can now search for the Sound Bar (VIZIO SB3820) using your Bluetooth device. For more information, refer to the user documentation that came with the device.
3. Play audio from your Bluetooth device. Volume can be controlled on your source device and the Sound Bar.



Bluetooth Device



Top of Sound Bar

## USING BLUETOOTH MODE

Your Sound Bar supports music streaming from smartphones, tablets, and computers with Bluetooth capability. Device compatibility will vary, see your device's documentation for more information. Once you have paired your source device to the Sound Bar, as long as you stay within range of the Sound Bar, your device should remain paired, even if you change the input on the Sound Bar.



Your Sound Bar is not equipped with a microphone, so it cannot operate as a hands-free device for a smartphone.

### Maximizing Signal

A Bluetooth signal has a range of up to 30 feet. Keep in mind that Bluetooth is a compressed audio format, so streamed music may lose some integrity when compared to a wired connection.

Try the following if your sound quality is less than optimal:

- If you hear any break-up or disconnect while streaming music from your device, move the source device closer to the Sound Bar.
- Be sure that there are no solid obstructions in the line-of-sight between the Sound Bar and the source device.
- Other wireless devices can affect Bluetooth range, including wireless security cameras, wireless video baby monitors, cordless phones, and microwave ovens. Turning off or moving these devices may improve Bluetooth range.



Reduce the volume levels on your device and on the Sound Bar before pressing Play. High volume levels can damage your hearing.

# ADVANCED SETUP

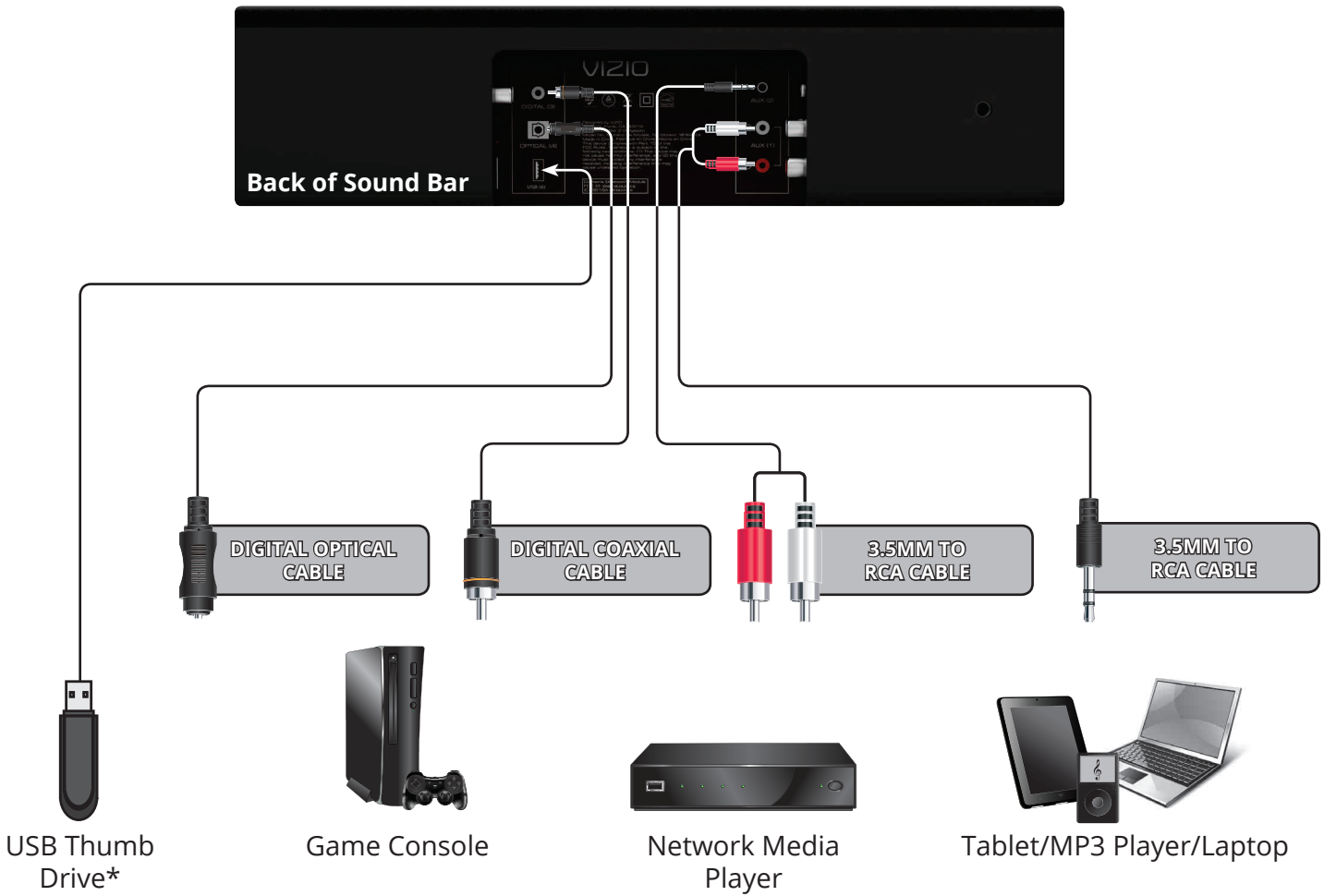

\* Supports .WAV file format playback only.



## CONNECTING A SUBWOOFER

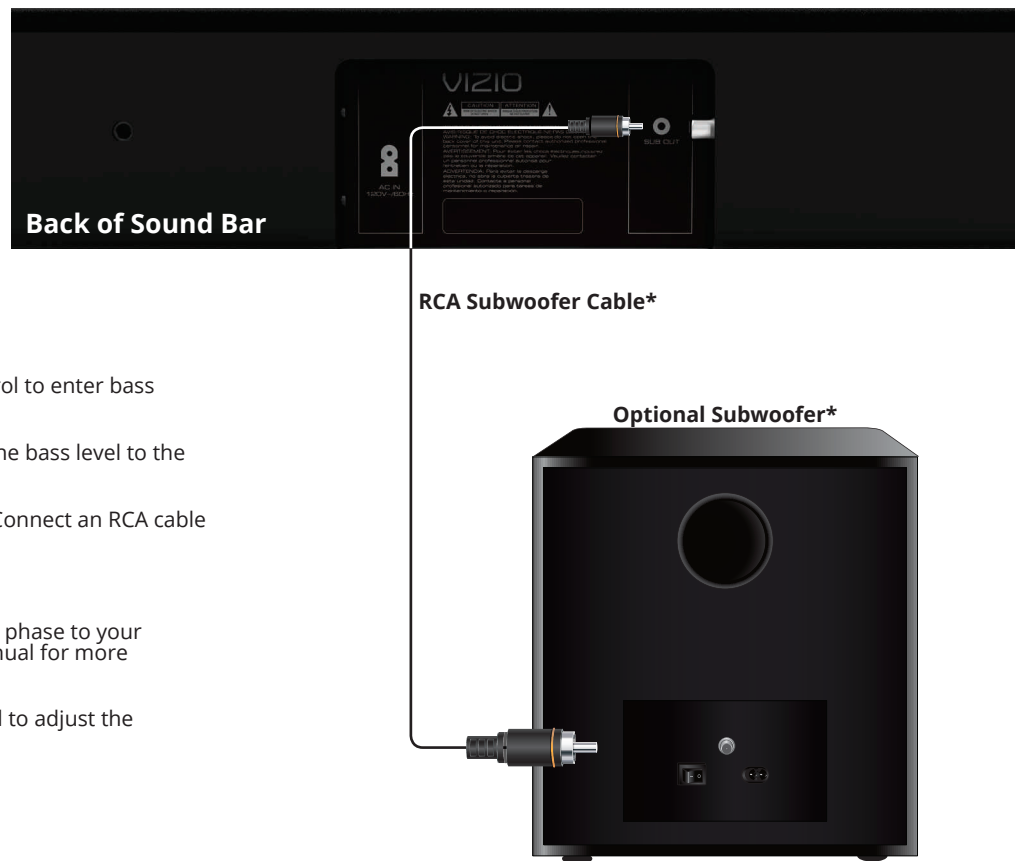

To connect a subwoofer:

1. Press the **BASS** button on the remote control to enter bass adjustment mode.
2. Use the **Previous/Next** buttons to adjust the bass level to the center position.
3. Power **Off** the Sound Bar and Subwoofer. Connect an RCA cable from the Sound Bar to the Subwoofer.
4. Power **On** the Sound Bar and Subwoofer.
5. Manually adjust the SUB gain (Volume) and phase to your preference. See your subwoofer's user manual for more information.
6. Use the **BASS** button on the remote control to adjust the subwoofer's output.

# USING BUTTON COMBINATIONS



Buttons are located here.

There are 3 functions that are triggered by 3 different button combinations on the Sound Bar.

Function	LED Behavior	Description
<b>Factory Reset</b>	<p>All 12 LEDs will flash 3 times</p>	<p>Reset the Sound Bar to the factory default settings. To perform a Factory Reset, <b>Press and Hold</b> the <b>Bluetooth</b> (⌘) and <b>Volume Down</b> (—) buttons for 5 seconds.</p> <p><b>Note:</b> This will erase all settings and preferences that you have set.</p>
<b>VIZIO TV Remote Control</b>	<p>← VIZIO TV Remote Enabled</p> <p>VIZIO TV Remote Disable →</p>	<p>Enable/disable the use of a VIZIO TV remote control to power on and adjust the volume of the sound bar. To enable/disable this function, <b>Press and Hold</b> the <b>Power</b> (⏻) and <b>Volume Up</b> (+) buttons for 5 seconds.</p> <p><b>Note:</b> This function is enabled by default.</p>
<b>Energy Star</b>	<p>← Energy Star Enabled</p> <p>Energy Star Disabled →</p>	<p>When the Energy Star setting is enabled, the sound bar will automatically power down after a period of inactivity. When disabled, the sound bar will remain powered on until you turn it off. To enable/disable this function, <b>Press and Hold</b> the <b>Power</b> (⏻) and <b>Volume Down</b> (—) buttons for 5 seconds.</p> <p><b>Note:</b> Energy Star setting is enabled by default.</p>

# WALL-MOUNTING THE SOUND BAR

1

Back of Sound Bar

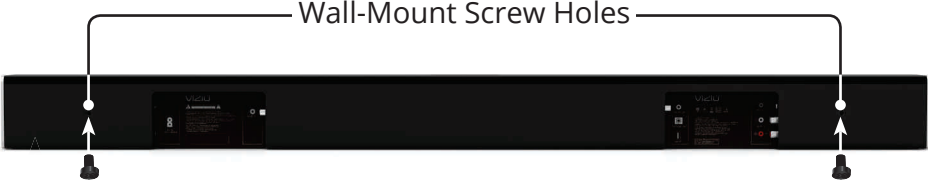

Insert the two wall-mount screws into the wall-mount screw holes, and then tighten them with a Phillips screwdriver.

2

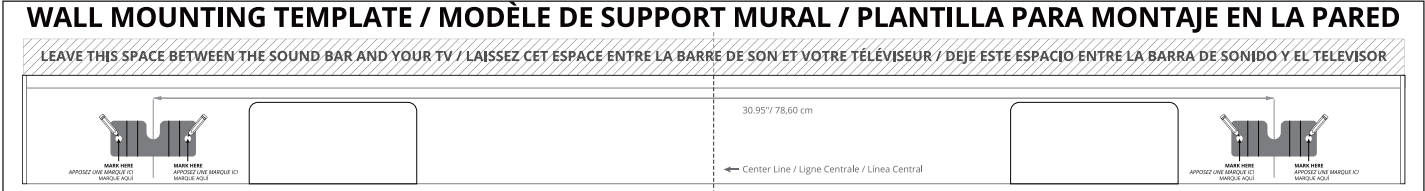

Place the included wall mounting template against the wall under your TV. Mark the four bracket holes using a pencil.

3

Be sure your screws are attached to wood studs, drywall anchors (for drywall), or concrete anchors (for brick/concrete walls).

Screws for attaching the brackets to the wall are not included. Choose the screw type and length appropriate to your home's construction. If in doubt, consult a professional installer.

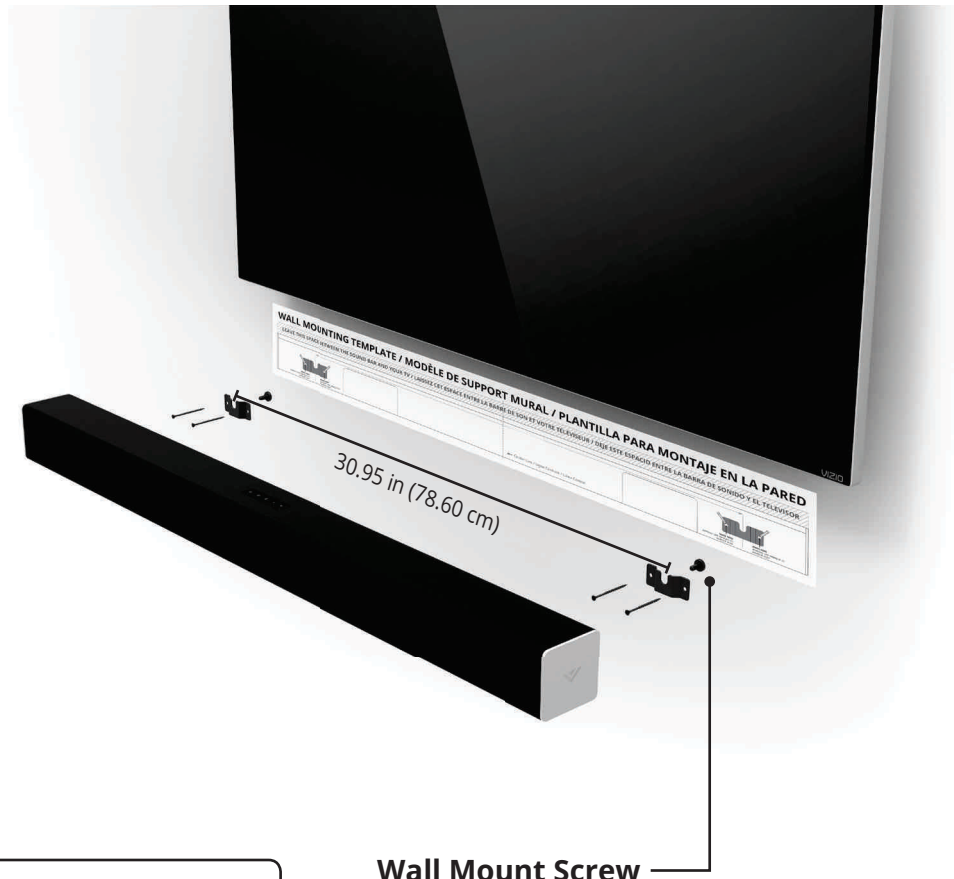

**Wall Mount Screw**  
Screw Size: M4 x 10



If you are unfamiliar with power tools or the layout of electrical wiring in the walls of your home, consult a professional installer.

# VIZIO RECOMMENDS



## Picture Perfect. Simply Smart.

All-new for 2015, the E-Series is packaged in a sleek new design. Experience more vibrant colors, more pronounced darks, more premium apps, and truly epic entertainment at an unbeatable value on the all-new, beautifully redesigned E-Series.

# VIZIO RECOMMENDS



## VIZIO High-Speed HDMI® Cable

This high-speed HDMI® cable is ideal for HDTVs. Supporting 1080p and 4k x 2k Ultra High Definition resolutions, the E-Series HDMI cable provides picture-perfect HD video, 3D, and superior audio, all at up to 18 Gbps. This all-in-one cable also supports advanced 7.1 surround sound and Audio Return Channel, eliminating the need for additional cables.

## HELP & TROUBLESHOOTING

There is no power.

- Press the **POWER** button on the remote control or on the top of your Sound Bar.
  - Ensure the power cord is securely connected.
  - Plug a different device into the electrical outlet to verify that the outlet is working correctly.
- 

There is no sound.

- Increase the volume. Press **Volume Up** on the remote control or on the top of your Sound Bar.
  - Press **MUTE** on the remote to ensure the Sound Bar is not muted.
  - Press **INPUT** on the remote or on the top of your Sound Bar to select a different input source.
  - When using either of the Digital Inputs, if there is no audio: (A) Try setting the TV output to PCM or (B) Connect directly to your Blu-ray/other source, some TVs do not pass through digital audio.
  - On digital inputs, the input LEDs will flash rapidly if an unsupported format is present. Set the source to output PCM.
  - Your TV may be set to variable audio output. Confirm that the audio output setting is set to **FIXED** or **STANDARD**, not **VARIABLE**. Consult your TV's user manual for more detailed information.
  - If using Bluetooth, ensure that the volume on your source device is turned up and that the device is not muted.
- 

I hear buzzing or humming.

- Ensure all cables and wires are securely connected.
  - Connect a different source device (TV, Blu-ray player, etc) to see if the buzzing persists. If it does not, the problem may be with the original device.
  - Connect your device to a different input on the Sound Bar.
- 

The remote isn't working.

- Replace the remote batteries with new ones.
- Point the remote directly at the center of the Sound Bar when pressing a button.
- If using a Bluetooth connection, some of the buttons on the remote may not be supported by the streaming application. (e.g., Pandora doesn't support the Back button.)

Take A Moment To Register Your Product At

**VIZIO.COM/PRODUCT-REGISTRATION**

## Why Register?



### **Customized Support**

Get assistance quickly with your information on-hand.



### **News & Offers**

Take advantage of the latest news and special offers from VIZIO.



### **Safety & Satisfaction**

Stay up to date with important product updates and notifications.

**REGISTER YOUR VIZIO PRODUCT NOW**



Do You Have Questions? Find Answers At

# SUPPORT.VIZIO.COM

## Find help with:

- New Product Setup
- Connecting Your Devices
- Technical Problems
- Product Updates
- And More



**Live Chat  
Support Available**

You can also contact our  
award-winning support team at:

Phone: (877) 878-4946 (TOLL-FREE)

Email: [techsupport@VIZIO.com](mailto:techsupport@VIZIO.com)

Hours Of Operation:

Monday - Friday: 7 AM TO 11 PM (CST)

Saturday - Sunday: 9 AM TO 6 PM (CST)



# ONE-YEAR LIMITED WARRANTY

## ON PARTS AND LABOR

Covers units purchased as new in United States and Puerto Rico Only

VIZIO provides a warranty to the original purchaser of a new Product against defects in materials and workmanship for a period of one year of non-commercial usage and ninety (90) days of commercial use. If a Product covered by this warranty is determined to be defective within the warranty period, VIZIO will either repair or replace the Product at its sole option and discretion. To obtain warranty service, contact VIZIO Technical Support via email: TechSupport@VIZIO.com or via phone at 877 MY VIZIO (877.698.4946) from 7:00AM to 11:00PM Monday through Friday and 9:00AM to 6:00PM Saturday and Sunday, Central Time, or visit [www.VIZIO.com](http://www.VIZIO.com). PRE-AUTHORIZATION MUST BE OBTAINED BEFORE SENDING ANY PRODUCT TO A VIZIO SERVICE CENTER. Proof of purchase in the form of a purchase receipt or copy thereof is required to show that a Product is within the warranty period.

## Parts and Labor

There will be no charge for parts or labor during the warranty period. Replacement parts and Products may be new or recertified at VIZIO's option and sole discretion. Replacement parts and Products are warranted for the remaining portion of the original warranty or for ninety (90) days from warranty service or replacement, whichever is greater.

## Type of Service

Defective Products must be sent to a VIZIO service center to obtain warranty service. VIZIO is not responsible for transportation costs to the service center, but VIZIO will cover return shipping to the customer. PRE-AUTHORIZATION IS REQUIRED BEFORE SENDING ANY PRODUCT TO A VIZIO SERVICE CENTER FOR WARRANTY SERVICE.

Product returns to VIZIO's service centers must utilize either the original carton box and shipping material or packaging that affords an equal degree of protection. VIZIO Technical Support will provide instructions for packing and shipping the covered Product to the VIZIO service center.

## Limitations and Exclusions

VIZIO's one-year limited warranty only covers defects in materials and workmanship. This warranty does not cover, for example: cosmetic damage, normal wear and tear, improper operation, improper voltage supply or power surges, signal issues, damages from shipping, acts of God, any type of customer misuse, modifications or adjustments, as well as installation and set-up issues or any repairs attempted by anyone other than by a VIZIO authorized service center. Products with unreadable or removed serial numbers, or requiring routine maintenance are not covered. This one year limited warranty does not cover Products sold "AS IS", "FACTORY RECERTIFIED", or by a non-authorized reseller.

THERE ARE NO EXPRESS WARRANTIES OTHER THAN THOSE LISTED OR DESCRIBED ABOVE. ANY IMPLIED WARRANTIES, INCLUDING ANY IMPLIED WARRANTY OF MERCHANTABILITY AND FITNESS FOR A PARTICULAR PURPOSE, SHALL BE LIMITED IN DURATION TO THE PERIOD OF TIME SET FORTH ABOVE. VIZIO'S TOTAL LIABILITY FOR ANY AND ALL LOSSES AND DAMAGES RESULTING FROM ANY CAUSE WHATSOEVER INCLUDING VIZIO'S NEGLIGENCE, ALLEGED DAMAGE, OR DEFECTIVE GOODS, WHETHER SUCH DEFECTS ARE DISCOVERABLE OR LATENT, SHALL IN NO EVENT EXCEED THE PURCHASE PRICE OF THE PRODUCT. VIZIO SHALL NOT BE RESPONSIBLE FOR LOSS OF USE, LOSS OF INFORMATION OR DATA, COMMERCIAL LOSS, LOST REVENUE OR LOST PROFITS, OR OTHER INCIDENTAL OR CONSEQUENTIAL DAMAGES. SOME STATES DO NOT ALLOW LIMITATIONS ON HOW LONG AN IMPLIED WARRANTY LASTS OR THE EXCLUSION OF INCIDENTAL OR CONSEQUENTIAL DAMAGES, SO THE ABOVE LIMITATIONS OR EXCLUSIONS MAY NOT APPLY TO YOU. THIS WARRANTY GIVES YOU SPECIFIC LEGAL RIGHTS, AND YOU MAY ALSO HAVE OTHER RIGHTS, WHICH VARY FROM STATE TO STATE. THIS WARRANTY IS SUBJECT TO CHANGE WITHOUT NOTICE. CHECK [www.VIZIO.com](http://www.VIZIO.com) FOR THE MOST CURRENT VERSION.

## Specifications

Sound Bar:	Two 2¾" Full-Range Drivers Two Passive Radiators	Sound Pressure Level (System):	100 dB
Inputs:	One 3.5mm Stereo Audio One RCA Stereo Audio One Optical (Toslink) One Digital Coaxial Audio Bluetooth (Wireless) One USB	Frequency Response (System):	60 Hz to 19 KHz
		Voltage:	120 VAC, 60 Hz
		Compliances:	UL, FCC, cUL, NRCAN, NOM

# LEGAL & COMPLIANCE

## FCC Class B Radio Interference Statement

NOTE: This equipment has been tested and found to comply with the limits for a Class B digital device, pursuant to Part 15 of the FCC Rules. These limits are designed to provide reasonable protection against harmful interference in a residential installation. This equipment generates, uses and can radiate radio frequency energy, and if not installed and used in accordance with the instructions, may cause harmful interference to radio communications. However, there is no guarantee that interference will not occur in a particular installation. If this equipment does cause harmful interference to radio or television reception, which can be determined by turning the equipment off and on, the user is encouraged to try to correct the interference by one or more of the following measures:

1. Reorient or relocate the receiving antenna.
2. Increase the separation between the equipment and receiver.
3. Connect the equipment into an outlet on a circuit different from that to which the receiver is connected.
4. Consult the dealer or an experienced radio/TV technician for help.

This device complies with Part 15 of the FCC Rules. Operation is subject to the following two conditions: (1) this device may not cause harmful interference, and (2) this device must accept any interference received, including interference that may cause undesired operation.

## Notice:

1. The changes or modifications not expressly approved by the party responsible for compliance could void the user's authority to operate the equipment.
2. Shielded interface cables and AC power cord, if any, must be used in order to comply with the emission limits.
3. The manufacturer is not responsible for any radio or TV interference caused by unauthorized modification to this equipment. It is the responsibilities of the user to correct such interference.

## RF Exposure Information

This device meets the government's requirements for exposure to radio waves. This device is designed and manufactured not to exceed the emission limits for exposure to radio frequency (RF) energy set by the Federal Communications Commission of the U.S. Government. This device complies with FCC radiation exposure limits set forth for an uncontrolled environment.

## IC Statement

1. This device complies with Industry Canada licence-exempt RSS standard(s). Operation is subject to the following two conditions:
  - (1) this device may not cause interference, and
  - (2) this device must accept any interference, including interference that may cause undesired operation of the device.
2. Changes or modifications not expressly approved by the party responsible for compliance could void the user's authority to operate the equipment.
1. Le présent appareil est conforme aux CNR d'Industrie Canada applicables aux appareils radio exempts de licence. L'exploitation est autorisée aux deux conditions suivantes:
  - (1) l'appareil ne doit pas produire de brouillage, et
  - (2) l'utilisateur de l'appareil doit accepter tout brouillage radioélectrique subi, même si le brouillage est susceptible d'en compromettre le fonctionnement.

## IC Radiation Exposure Statement

This equipment complies with IC RSS-102 radiation exposure limits set forth for an uncontrolled environment. This equipment should be installed and operated with minimum distance 20cm between the radiator & your body.

## Disposal and Recycling

You must dispose of this product properly, according to local laws and regulations. Because this product contains electronic components and a battery, it must be disposed of separately from household waste. Contact local authorities to learn about disposal and recycling options.

## Other:

Image(s) used under license from Shutterstock.com



Manufactured under license from Dolby Laboratories. Dolby and the double-D symbol are trademarks of Dolby Laboratories.



For DTS patents, see <http://patents.dts.com>. Manufactured under license from DTS Licensing Limited. DTS, the Symbol, & DTS and the Symbol together are registered trademarks, and DTS TruSurround is a trademark of DTS, Inc. DTS, Inc. All Rights Reserved.



For DTS patents, see <http://patents.dts.com>. Manufactured under license from DTS Licensing Limited. DTS, the Symbol, & DTS and the Symbol together are registered trademarks, and DTS TruVolume is a trademark of DTS, Inc. © DTS, Inc. All Rights Reserved.



This product qualifies for ENERGY STAR in the "factory default" setting and this is the setting in which power savings will be achieved. Changing the factory default settings or enabling other features will increase power consumption that could exceed the limits necessary to qualify for ENERGY STAR rating.

We want to help you save energy.

